

FEMALE END VIEW

BOARD LAYOUT TYPICAL

SPECIFICATIONS

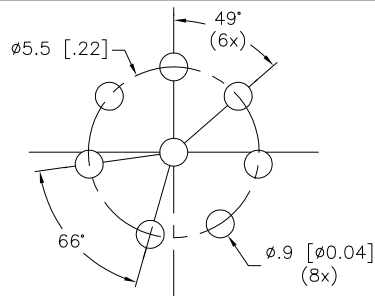
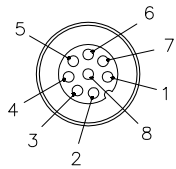

CONTACT CARRIER MATERIAL	NYLON OR TPU
CONTACT MATERIAL/PLATING	BRASS/GOLD
RATED CURRENT [A]	1.5 A
RATED VOLTAGE [V]	30 VAC/36 VDC
NUMBER OF CONDUCTORS [AWG]	PRINTED CIRCUIT PINS
TEMPERATURE RATING	-30°C TO +80°C (-22°F TO +176°F)



SCALE: 1=2

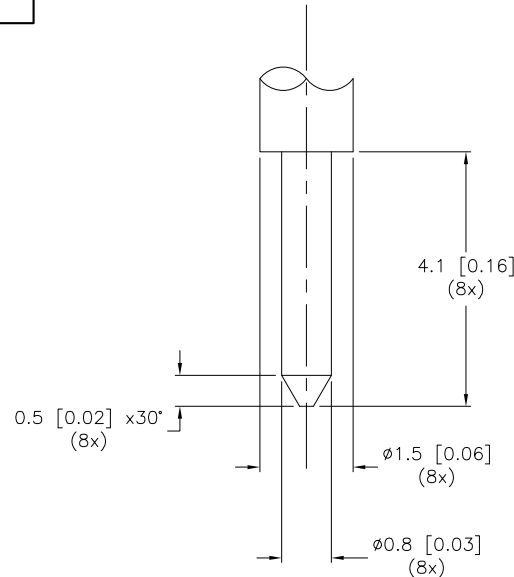
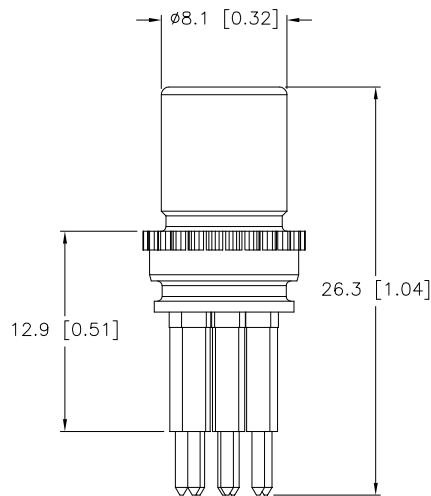
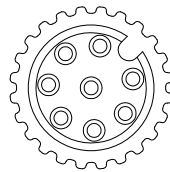

DETAIL A
SCALE: 1=4

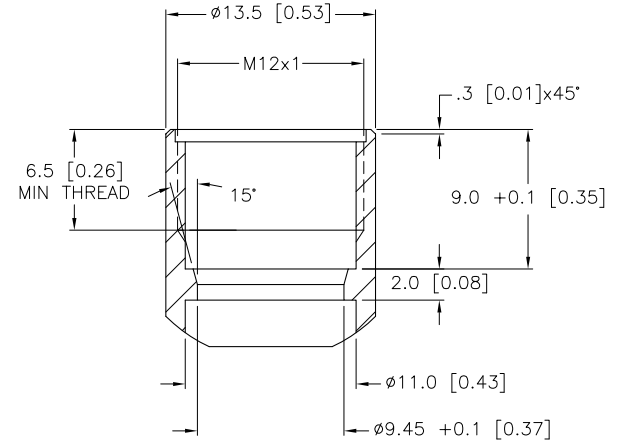

RECOMMENDED O-RING SIZE
7.0mm x 1.5mm

MOUNTING BORE
(TYPICAL)

SOURCE DRAWING - FOR REFERENCE ONLY

RELATED DOCUMENTS 1. 2. 3. 4.	3RD ANGLE PROJECTION 	THIS DRAWING IS CONFIDENTIAL AND THE PROPERTY OF TURCK INC. USE OF THIS DOCUMENT WITHOUT WRITTEN PERMISSION IS PROHIBITED.		TURCK INC High Technology Sensors and Automation Controls 3000 CAMPUS DRIVE MINNEAPOLIS, MN 55441 1-800-544-7769 (763) 553-7300 (763) 553-0708 fax turck.com	
	MATERIAL	DRFT RDS	DATE 05/12/10	DESCRIPTION EWAK 8-PCB(10/BAG)	
FINISH	ALL DIMENSIONS DISPLAYED ON THIS DRAWING ARE FOR REFERENCE ONLY	APVD	SCALE 2=1.0	IDENTIFICATION NO. A9170	
A	DRAWING RELEASE AND PROCESSED ECO 37423	KMY	12/08/11	37423	REV A
REV	DESCRIPTION	BY	DATE	ECO NO.	DO NOT SCALE THIS DRAWING
					FILE: A9170
					SHEET 1 OF 1